

Installation Instructions

1. Before installing Protecta® FR Acrylic ensure that the surface of all service penetrations and surrounding construction is free from all loose contaminants, dust and grease.
2. Where Protecta® FR Acrylic is to be installed against surfaces that cannot tolerate direct contact; appropriate surface preparation should be made (contact Polyseam for guidance in these cases). For paints sensitive to sealing compounds, priming with a PVA primer is recommended.
3. When installing any backing material, cut this slightly oversize and insert into the gap ensuring a tight friction fit. Ensure correct depth is achieved.
4. Fill the gap or joint with Protecta® FR Acrylic to the required depth.
5. Apply the sealant generously to prevent air bubbles. Finish the bead with a moist spatula, pallet knife or brush.
6. Protecta® FR Acrylic can be over-painted with most emulsion or alkyd (gloss) paints.

Protecta FR Acrylic Concrete Floor Slab or Floor/Wall Joints Steel/Aluminium/Concrete Gaps to 30mm

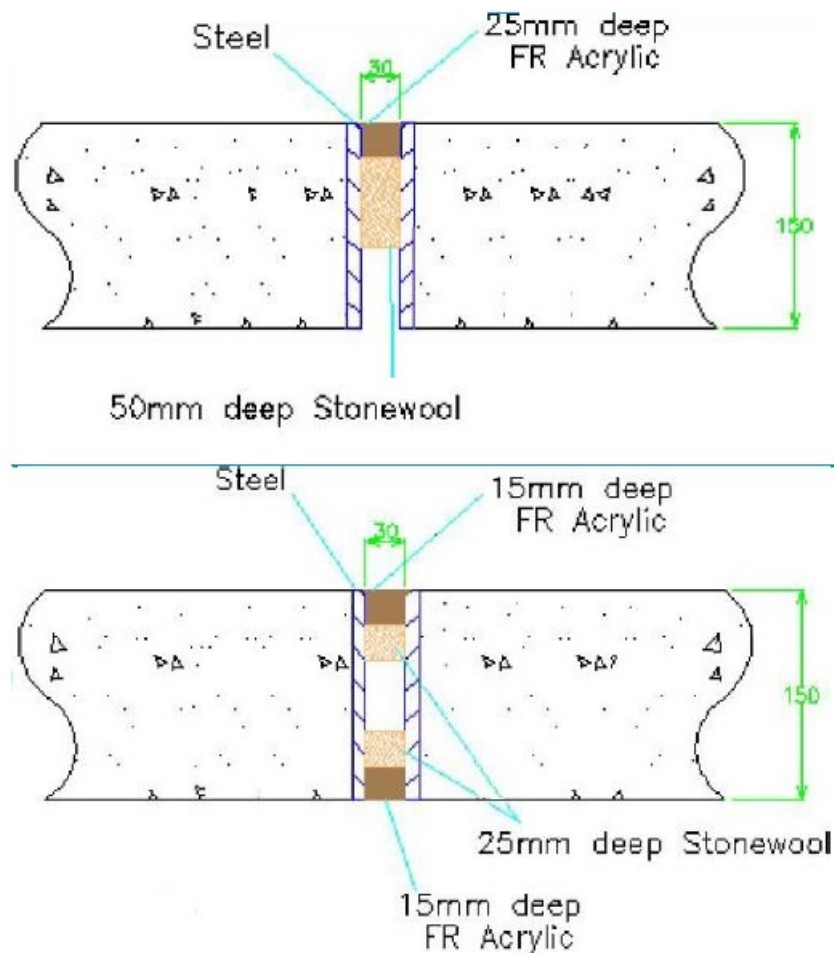

System/FPA Register ID# FC412

Products	Protecta FR Acrylic
Application	Fire rated linear seals in rigid floors or between floors and walls
Construction	Minimum floor thickness of 100mm and comprise aerated concrete or concrete with a minimum density of 650kg/m ³ .

Fire & Sound classification

Steel to Steel, Steel to Concrete - top seal - up to 30mm wide with 35kg/m³ stone wool
FRR -/240/60

Aluminium to Concrete - top seal - up to 30mm wide with stone wool ≥ 35kg/m³
FRR -/180/60

Steel to Steel or Steel to Concrete - top and bottom seal up to 30mm wide with 35kg/m³ stone wool
FRR -/240/120

Note that thermal ratings given exclude the steel or aluminium which will have lower thermal ratings than concrete and may require additional insulation.

Floors down to 100mm permitted with FRR of system reduced to FRR of floor

ZERO smoke leakage up to 200Pa

Sound reduction (seal only) STC 62

Sheet size: **A4**
Drawn date & no: 24/5/21

Scale: **NTS**
Drawn by: K.B

As a part of our policy of on-going product development and testing, we reserve the right to modify, alter or change product specifications without giving notice. All information contained in this document is given in good faith and is provided for guidance only. Any drawings provided are for illustrative purposes only. As Polyseam has no control over the methods or competence of installation and of prevailing site conditions, no warranties, expressed or implied, is intended to be given as to the actual performance of the product mentioned or referred to herein and no liability whatsoever will be accepted for any loss, damage or injury arising from the use of the information given.